

**TENANT LEGEND**

SUITE	TENANT	SF
4	FOOD 4 LESS	39,674 sf
8	PASADENA FEDERAL CREDIT UNION	2803 sf
10	WATERIA	500 sf
14	OPORTUN	902 sf
16	WING STOP	1203 sf
18		1204 sf
20	EXPERT NAILS	904 sf
22	T MOBILE	1970 sf
24	PIZZA HUT	1127 sf
26	VIP TOBACCO	1037 sf
28	FRED LOYA INSURANCE	1410 sf
30	SUBWAY	1412 sf
32	MAKI YAKI	1010 sf
36		2100 sf
40		3601 sf
42	ACE THREADING	825 sf
44		1100 sf
46	SALSA PICANTE	825 sf
48	FISHBONE SEAFOOD	825 sf
52	BEAUTY CLUB PLUS	5474 sf
54	WESTERN DENTAL	3939 sf
58	ONE UNITED BANK	7000 sf

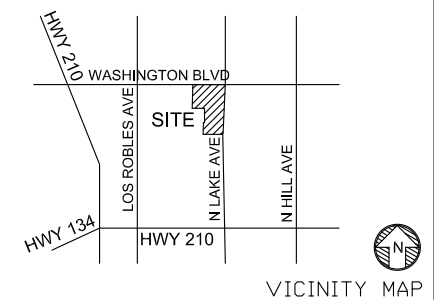

TOTAL BUILDING SF:	80,845 SF
PARKING PROVIDED:	278 STALLS
PARKING RATIO:	3.43/1000 SF
TRAFFIC COUNTS:	46,121 ADT (2003)
DEMOGRAPHICS	1 MILES    3 MILES    5 MILES
2020 EST. POP.	36,663    175,327    356,122
2025 PROJ. POP.	36,777    178,474    359,625
AVG. HH. INCOME	103,463    125,758    136,836

CLAREMONT AVE.

WASHINGTON AVENUE

LAKE AVENUE



**NORTH LAKE SQUARE**

1241-1337 N. LAKE AVENUE PASADENA, CA 91104

**SITE LEASE PLAN**

DISCLAIMER: THIS PLAN IS PROVIDED SUBJECT TO (i) ERRORS AND OMISSIONS IN THE INFORMATION AND (ii) MODIFICATION WITHOUT NOTICE. THE INFORMATION, SPECIFICATIONS, DIMENSIONS AND/OR TABULATIONS SET FORTH IN THIS PLAN HAVE BEEN DERIVED FROM DOCUMENTS BELIEVED TO BE RELIABLE. HOWEVER, THIS PLAN MAY BE INCOMPLETE AND/OR INACCURATE. NO REPRESENTATION OR WARRANTY, EXPRESSED OR IMPLIED AS TO THE ACCURACY OR ADEQUACY REGARDING SUCH INFORMATION IS MADE BY THE OWNER OF THE PROJECT, PROPERTY MANAGER OR ANY OTHER REPECTIVE PARTNERS, DIRECTORS, OFFICERS, EMPLOYEES AND AGENTS. NONE OF THE FOREGOING PARTIES SHALL HAVE ANY LIABILITY FOR SUCH ERRORS, OMMISIONS, INCOMPLETENESS OR INACCURACIES. ANY PERSON OR ENTITY REVIEWING THIS PLAN SHOULD MAKE THEIR OWN INDEPENDENT INVESTIGATION OF THE INFORMATION CONTAINED HEREIN.



SCALE: 0' 30' 60'

May. 15, 22

SHEET 1 OF 1